

**3M** Science.  
Applied to Life.™

Water Purifier  
**Trust in  
Every Drop**

OVER  
**75**  
YEARS  
Water Filtration  
Expertise



# All-in-One Stage : Carbon Block Technology

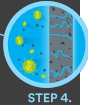
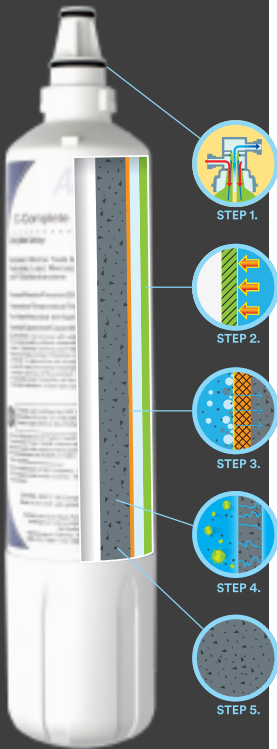

## Step 1 : Close system

Rigid Polypropylene design that can prevent any possible contaminants go into the filter cartridge.

## Step 2 : High quality of materials

High quality that can operate the system up to 120 psi with FDA CFR-21 compliant.

## Step 3 : Sediment reduction

As made from high quality of Polypropylene that can reduce dirt, sediment and rust.

## Step 4 : Harmful contaminant reduction

The Activated Carbon Block of 0.5 micron filter is capable to reduce harmful contaminant up to 99.9%.\*

\* Protozoan Cysts

## Step 5 : Chemical contaminant reduction

The filter is capable to reduce Chlorine, Selected VOCs, Lead and Mercury.\*\*

\*\* for AP Easy Complete cartridge model

# IMPACT Technology



## Step 1 : Close system

Rigid Polypropylene design that can prevent any possible contaminants go into the filter cartridge.

## Step 2 : Sediment reduction

As made from high quality of Polypropylene that can reduce dirt, sediment and rust.

## Step 3 : Cyst and Water-Borne bacteria reduction

Pleated membrane design helps provide cyst and bacteria protection and superior sediment holding capabilities.\*

\* More than 99.9% of E.coli bacteria are reduced by the nylon pharmaceutical grade membrane

## Step 4 : Harmful contaminant reduction

Carbon Block technology helps provide chlorine taste and odor reduction. Also features bacteria inhibition agent for improved hygiene.

## Step 5 : Chemical contaminant reduction

The filter is capable to reduce Chlorine, Selected VOCs, Lead and Mercury.\*\*

\*\* for DWS160-L and DWS2500T cartridge models





# Shower Filter

- Filter cartridge model : SFKCO1-CN1
- Efficient removal rating at 50 micron
- Efficient capacity at 50,000 liters\*
- Flow rate at 8.0 LPM
- Reduce Chlorine and Lead from incoming water that could cause skin allergy
- Tested in accordance of NSF 177
- FDA CFR-21 compliant materials

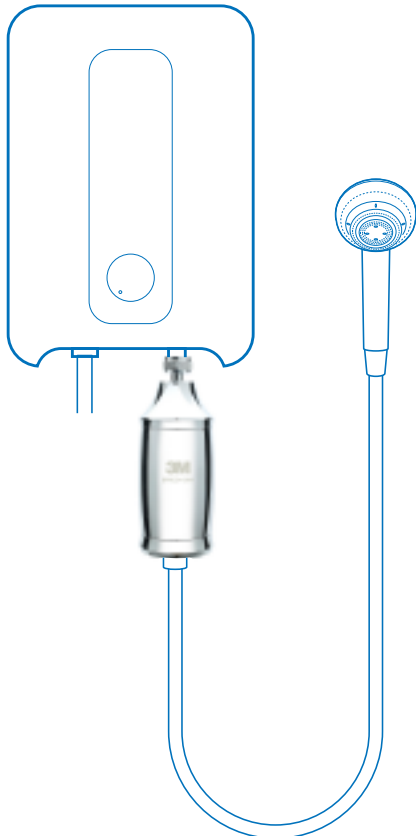

## Removal Capability

Main connecting	Chlorine	Lead	Operational Temperature
1/2" connection	✓	✓	5 - 50°C

\* Depends on water inlet quality

# DIY

- All-in-One stage cartridge : Carbon Block Technology
- Filter cartridge model : AP Easy Complete
- Efficient removal rating at 0.5 micron
- Efficient capacity at 2,800 liters\*
- Flow rate at 2.0 LPM
- Select VOCs : reduction for Atrazine, Benzene, Carbofuran, Dichlorobenzene, Lindane, Toxophene
- Sanitary Quick Change (SQC) design
- NSF 42, 53 certified and FDA CFR-21 compliant materials



## SQC (Sanitary Quick Change)

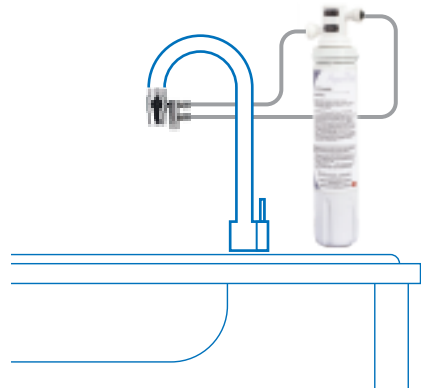

## Removal Capability

Main connecting	Dirt, Rust, Sediment	Chlorine	Taste & Odor	Turbidity	Lead	Mercury	Protozoan Cysts	VOCs **
✓ Diverter Valve	✓	✓	✓	✓	✓	✓	✓ 99.9% removal	✓ Selected VOCs

\* Depends on water inlet quality

\*\* Volatile Organic Compounds

# Counter Top

- All-in-One stage cartridge : Carbon Block Technology
- Filter cartridge model : AP Easy Complete
- Efficient removal rating at 0.5 micron
- Efficient capacity at 2,800 liters\*
- Flow rate at 2.0 LPM
- Select VOCs : reduction for Atrazine, Benzene, Carbofuran, Dichlorobenzene, Lindane, Toxophene
- Sanitary Quick Change (SQC) design
- NSF 42, 53 certified and FDA CFR-21 compliant materials



## SQC (Sanitary Quick Change)



## Removal Capability

Main connecting	Dirt, Rust, Sediment	Chlorine	Taste & Odor	Turbidity	Lead	Mercury	Protozoan Cysts	VOCs **
✓ Diverter Valve	✓	✓	✓	✓	✓	✓	✓ 99.9% removal	✓ Selected VOCs

\* Depends on water inlet quality

\*\* Volatile Organic Compounds

# Undersink

- All-in-One stage cartridge : Carbon Block Technology
- Filter cartridge model : AP Easy Cyst
- Efficient removal rating at 0.5 micron
- Efficient capacity at 7,500 liters\*
- Flow rate at 5.7 LPM
- Sanitary Quick Change (SQC) design
- NSF 42, 53 certified and FDA CFR-21 compliant materials



## SQC (Sanitary Quick Change)

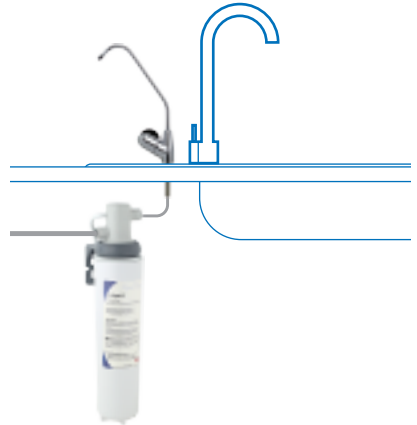

## Removal Capability

Main connecting	Dirt, Rust, Sediment	Chlorine	Taste & Odor	Turbidity	Protozoan Cysts
✓ Dedicated drinking faucet	✓	✓	✓	✓	✓ 99.9% removal

\* Depends on water inlet quality

# Undersink - Large

- IMPACT Technology
- Filter cartridge model: DWS160-L
- Efficient removal rating at 0.2 micron
- Efficient capacity at 22,700 liters\*
- Flow rate at 9.4 LPM
- Select VOCs: reduction for Atrazine, Benzene, Carbofuran, Dichlorobenzene, Lindane, Toxophene
- Sanitary Quick Change (SQC) design
- NSF 42, 53 certified and FDA CFR-21 compliant materials



## SQC (Sanitary Quick Change)



## Removal Capability

Main connecting	Dirt, Rust, Sediment	Chlorine	Taste & Odor	Turbidity	Lead	Protozoan Cysts	Water-borne Bacteria **	VOCs ***
✓ Dedicated drinking faucet	✓	✓	✓	✓	✓	✓ 99.9% removal	✓ 99.9% removal	✓ Selected VOCs

\* Depends on water inlet quality

\*\* E.Coli

\*\*\* Volatile Organic Compounds



# Membrane

- IMPACT Technology
- Filter cartridge model: DWS2500-T
- Efficient pre-filter removal rating at 3 micron
- Efficient post-filter removal rating at 0.2 micron
- Efficient capacity at 2,850 liters\*
- Flow rate at 2.85 LPM
- Full VOCs: reduction for Atrazine, Benzene, Carbofuran, Dichlorobenzene, Lindane, Toxophene for example
- LED faucet light indicator (no electricity use)
- Sanitary Quick Change (SQC) design
- NSF 42, 53 certified and FDA CFR-21 compliant materials



## SQC (Sanitary Quick Change)



## Removal Capability

Main connecting	Dirt, Rust, Sediment	Chlorine	Taste & Odor	Turbidity	Lead	Protozoan Cysts	Water-borne Bacteria **	VOCs ***
✓ Dedicated drinking faucet	✓	✓	✓	✓	✓	✓ 99.9% removal	✓ 99.9% removal	✓ full VOCs

\* Depends on water inlet quality

\*\* E.Coli

\*\*\* Volatile Organic Compounds





# AP902 Whole House Filter

- Pleated PP Technology
- Filter cartridge model : AP910R
- Efficient removal rating at 5 micron
- Efficient capacity at 300,000 liters\*
- Flow rate at 75.7 LPM
- 304 Stainless steel filter head for outdoor installation
- Sanitary Quick Change (SQC) design
- NSF 42 certified and FDA CFR-21 compliant materials



## SQC (Sanitary Quick Change)



## Removal Capability

Main connecting	Dirt, Rust, Sediment	Turbidity
1" connection	✓	✓

\* Depends on water inlet quality

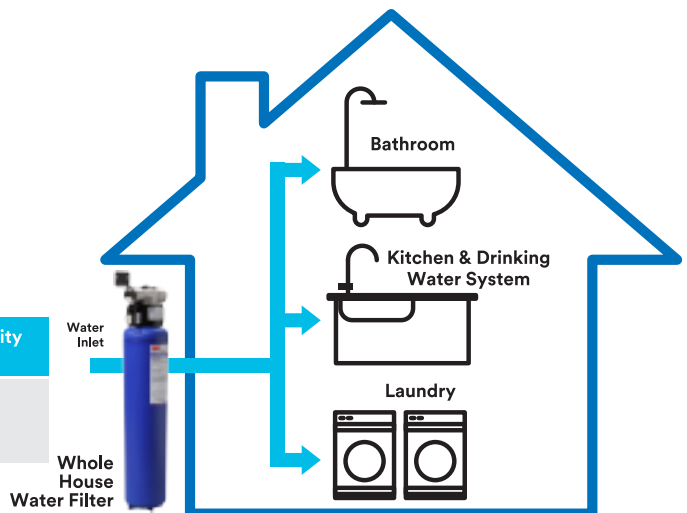



# HCD-2 Water Dispenser

- Carbon Block and UV Technologies
- Filter cartridge model : AP2-C405SG
- Efficient post-filter removal rating at 0.5 micron
- Efficient capacity at 4,000 liters\*
- Flow rate at 2 LPM
- Select VOCs : reduction for Benzene, Dichlorobenzene and Toxophene
- Remove slime, rust and aesbestoes by 99.9%
- Sanitary Quick Change (SQC) design
- Storage capacity (8.17 L) : Ambient 4.6 L, Cold 3 L, Hot 0.57 L.
- Dimension : 290x497x474 mm
- Weight : 17.7 kg
- Tested in accordance of NSF 42, 53
- FDA CFR-21 compliant materials



free of bisphenol A (BPA)



FDA CFR-21 compliant materials



Certified by Water Regulations Advisory Scheme (WRAS)



Certified by The Water Quality Association (WQA)



99.9% removal for Protozoan cyst and E. Coli



### 3 Stage Filtration

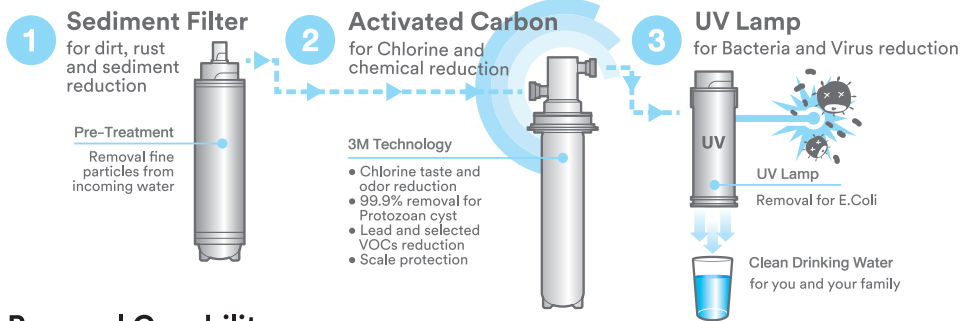

### Removal Capability

Main connecting	Dirt, Rust, Sediment	Chlorine	Taste & Odor	Turbidity	Lead	Scale formation	Protozoan Cysts	Water-borne Bacteria **	VOCs ***
1/4" connection	✓	✓	✓	✓	✓	✓	✓ 99.9% removal	✓ 99.9% removal	✓ Selected VOCs

\* Depends on water inlet quality

\*\* E. Coli

\*\*\* Volatile Organic Compounds

# Cleaner, Clearer and better tasting water for you and your family.

## 3M Separation and Purification Sciences Division

is a trusted expert in filtration with over 75 years of experience for water filtration. Our filtration technology has been proven in the most demanding & challenging applications which includes pharmaceutical laboratories, manufacturing facilities and restaurant chains.



**3M Purification Inc.**  
400 Research Parkway  
Meriden, CT 06450, U.S.A.  
Tel (800) 222-7880 (203) 237-5541  
Fax (203) 238-8701  
[www.3Mpurification.com](http://www.3Mpurification.com)

**Separation and Purification Sciences Division  
3M Thailand Limited**  
12th Floor, Serm-Mit Tower  
159 Asoke-Montri Road  
Klongtoey Nua, Wattana, Bangkok 10110  
0-2260-8577 Fax 0-2261-7535  
[www.3m.com/th](http://www.3m.com/th), [www.facebook.com/3Mthailand](https://www.facebook.com/3Mthailand)



### **SIGMA TECHNOLOGIES PVT LTD**

Prasuti Griha Marg, Thapathali, Kathmandu, Nepal  
Tel: +977 1 4262184, Fax: +977 1 4258634  
Mobile: 9809183636  
Email: [info@3mwaternepal.com](mailto:info@3mwaternepal.com)

**URL: [fb.com/3mwaternepal](https://fb.com/3mwaternepal), [www.3mwaternepal.com](http://www.3mwaternepal.com)**